

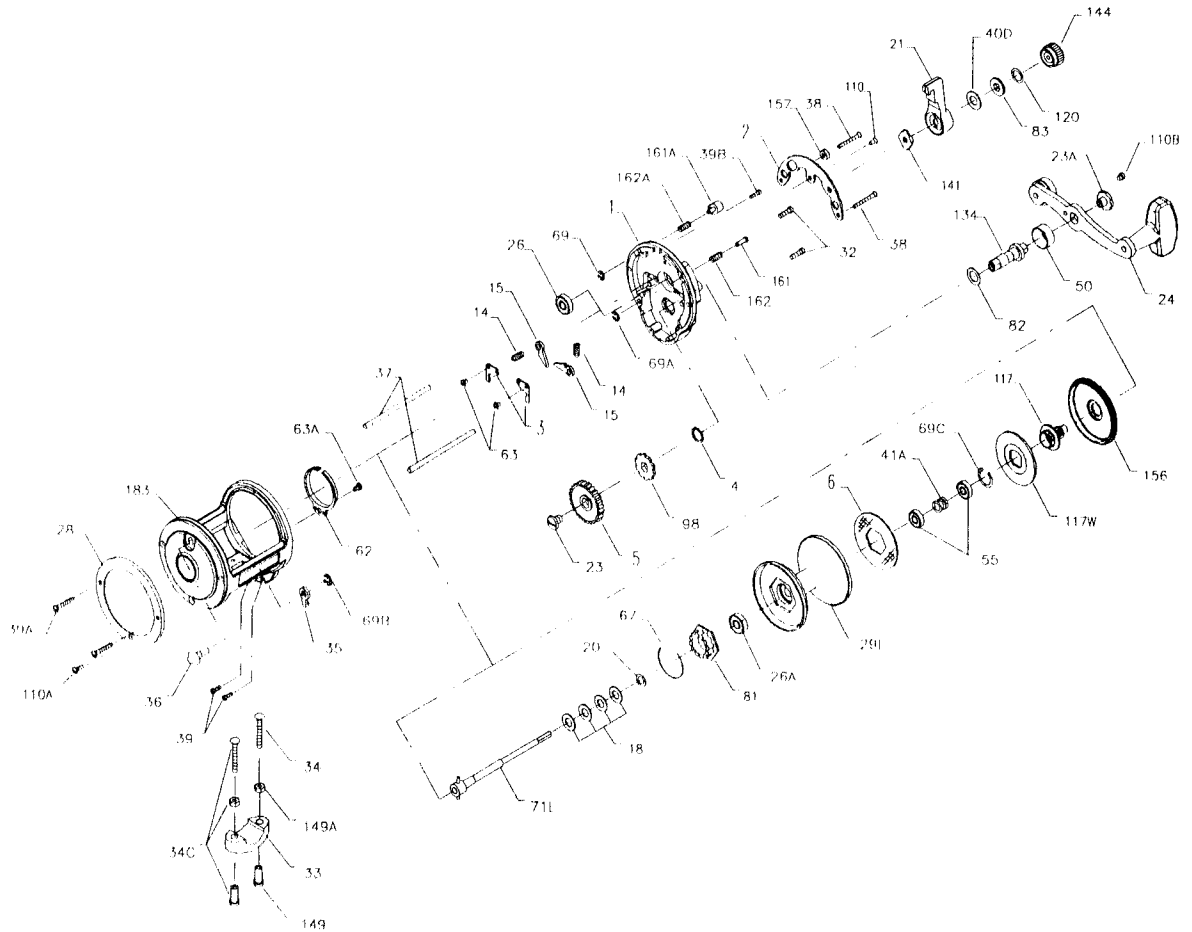

PARTS AND PRICE LIST FOR MODEL 225LD



Key No.	Part No.	Description	Price	Key No.	Part No.	Description	Price
1	001 225	Right Side Plate	\$9.45	50	050 025	Gear Stud Cover	\$2.00
2	002 025	Quadrant Ring	5.70	55	055 116	Spool Bearing (2 req.)	8.25
3	003 225	Dog Bridge (2 req.)	1.50	62	062 025	Click Spring	1.75
4	004 025	Gear Stud Washer	.55	63	063 500S	Bridge Mounting Screw (2 req.)	.80
5	005 225	Main Gear	8.65	63A	063 500S	Click Spring Screw	.80
6	006 225	Drag Washer HT-100	6.00	67	067 025	Ratchet Retaining Ring	.80
13	013N025	Pinion Gear	6.65	69	069B050	Strike Button Retaining Ring	.80
14	014 099	Dog Spring (2 req.)	.45	69A	069B050	Free Spool Button Retaining Ring	.80
15	015N025	Dog (2 req.)	1.35	69B	069B600	Click Tongue Retaining Ring	.90
18	018 040	Clutch Disc Spring (4 req.)	.80	69C	069C225	Retaining Ring	.90
20	020 040	Thrust Washer	.50	71L	071L225	Spindle Spool Assembly	8.50
21	021R225	Drag Cam Lever	5.25	81	081 025	Click Ratchet	2.70
23	023 006CH	Gear Mounting Screw	1.40	82	082 025	Handle Shim	.45
23A	023 114	Handle Screw	2.65	83	083 225	Preset Collar	2.70
24	024 225	Handle	8.75	98	098 225	Main Gear Ratchet	1.75
26	026N025	Ball Bearing Drive Plate	11.00	110	110 050	R.S. Quadrant Screw	.50
26A	026N025	L.S. Spool Bearing	11.00	110A	110 050	L.S. Stand Screw	.50
28	028 025	L.S. Ring	5.00	110B	110 060	Handle Lock Screw	.45
29L	029L225N	Spool	26.00	117	117 225	Drive Plate Assembly	15.00
32	031 210	Lower Plate Screw (2 req.)	.40	117W	117W225	Drive Plate Washer	2.50
33	033 113	Rod Clamp	4.00	120	120 113H	O-Ring	.50
*	*033R200	Ringed Rod Clamp (Optional)	6.25	134	134 025	Gear Stud	5.45
34	034 045	Clamp Screw (Only)	1.00	*	*134A025	Gear Stud Washer	.60
34C	034C045	Rod Clamp Screw w/Nuts	2.50	141	141 225	Cam Follower	2.50
35	035 025	Click Tongue	1.25	144	144 025	Preset Knob	6.10
36	036 025	Click Button	1.00	149	149 045	Clamp Nut (2 req.)	1.00
37	037 040	Post (2 req.)	1.95	149A	149 200	Hex Nuts (2 req.)	.50
38	038 040	R.S. Post Screw (2 req.)	.40	156	156 225	Drag Cover	2.70
39	046 4300	Frame Screw (2 req.)	.50	157	157 225	Quadrant Spacer	.75
39A	039 009	L.S. Post Screw (2 req.)	.40	161	161 025	Free Spool Button	1.25
39B	032 002	R.S. Screw	.40	161A	161 040	Strike Button	1.30
40D	040D025	Friction Washer	.50	162	162 050	Free Spool Button Spring	.50
41	041N045	Preset Knob Spring	1.00	162A	162 050	Strike Button Spring	.50
41A	041 225	Bearing Spring	4.00	183	183 225	Frame	33.00